

BUILDING PLAN NOTES

- DO NOT SCALE DRAWINGS USE FIGURE DIMENSIONS ONLY. CONTRACTOR SHALL VERIFY ALL DIMENSIONS AND CONDITIONS, IN THE EVENT OF A CONFLICT NOTIFY ARCHITECT BEFORE PROCEEDING.
- BUILDING FOOTPRINT SHOWN FOR DIMENSION AND NOTES PURPOSE ONLY, REFER TO SITE PLAN FOR ACTUAL BUILDING ORIENTATION.
- REFER TO CIVIL DRAWINGS AND ARCHITECTURAL SITE PLAN FOR SIDEWALKS CONTINUATION. EXTERIOR WALKWAYS TO BE SLOPED AWAY FROM THE BUILDING ENTRANCES AT 1 TO 20 SLOPE (REFER TO CIVIL GRADING PLANS).
- SOIL TO BE TREATED FOR TERMITES BEFORE POURING SLABS.GENERAL CONTRACTOR TO PROVIDE TO THE BUILDING DEPARTMENT A CERTIFICATE OF COMPLIANCE PREPARED BY A LICENSED PEST CONTROL COMPANY THAT CONTAINS THE FOLLOWING STATEMENT:"THE BUILDING HAS RECEIVED A COMPLETE TREATMENT FOR THE PREVENTION OF SUBTERRANEAN TERMITES, TREATMENT IS IN ACCORDANCE WITH RULES AND LAWS ESTABLISHED BY THE FLORIDA DEPARTMENT OF AGRICULTURE AND CONSUMER SERVICES" PER F.B.C. 7th EDITION (2020) SECTION 1816.1.7
- STORAGE AREA UNDER STAIRS FOR ELECT. CLOSETS ONLY.
- REFER TO TABLES 601 & TABLE 602 ON SHEET A0.04 FOR BUILDING FIRE PROTECTION.
- REFER TO ARCHITECTURAL SITE PLAN FOR ELECTRICAL ROOM, TELEPHONE/CABLE ROOM AND FIRE SPRINKLER CABINET LOCATION AND ORIENTATION.
- EACH BUILDING SHALL HAVE ITS OWN FIRE ALARM CONTROL PANEL FOR OCCUPANCT NOTIFICATION AND MONITORING OF THE FIRE SPRINKLER SYSTEM (SEE FIRE PREVENTION DOCUMENTS).
- BUILDINGS TO BE EQUIPPED THROUGHOUT WITH AN APPROVED AUTOMATIC SPRINKLER SYSTEM IN ACCORDANCE WITH F.B.C. 2020 7TH EDITION, SECTION 903.3.1.2 (SEPARATE PERMIT REQUIRED).
- REFER TO SITE PLAN & ELECTRICAL DWGS FOR HEARING-IMPAIRED UNIT LOCATIONS.
- ALL FIRE RATED TENANT SEPARATIONS FROM SLAB TO SLAB, ALL FIRE AND SMOKE BARRIER PENETRATIONS TO BE PROTECTED.
- PROVIDE PERMANENTLY IDENTIFIED WITH SIGNS OR STENCILING IN A MANNER ACCEPTABLE TO THE AUTHORITY HAVING JURISDICTION IN ACCORDANCE WITH THE FLORIDA BUILDING CODE, SECTION 713.6 "FIRE WALLS, FIRE BARRIERS, FIRE PARTITIONS, SMOKE BARRIERS AND SMOKE PARTITIONS OR ANY OTHER WALL REQUIRED TO HAVE PROTECTED OPENINGS SHALL BE EFFECTIVELY AND PERMANENTLY IDENTIFIED WITH SIGNS OR STENCILING IN A MANNER ACCEPTABLE TO THE AUTHORITY HAVING JURISDICTION. SUCH IDENTIFICATION SHALL BE ABOVE ANY DECORATIVE CEILING AND IN CONCEALED SPACES. SUGGESTED WORDING FOR FIRE AND SMOKE BARRIERS: "FIRE AND SMOKE BARRIER - PROTECT ALL OPENINGS."
- LANDINGS SUBJECT TO WET CONDITIONS SHALL BE CONSTRUCTED TO PREVENT THE ACCUMULATION OF WATER (PER FBCA SEC. 405.10)

WALL TYPES:

- CONC. BLOCK W/ STUCCO FINISH EXTERIOR AND 5/8" GYP. BD ON 2X2 P.T FURRING
- NON RATED MTL. STUD PARTITION
- 1-HOUR RATED MTL PARTITION
- 1-HOUR RATED MTL PARTITION WITH CONC. FILLED STEEL COLUMN (PROVIDE MASTIC COATING ON EXPOSED -NON PROTECTED STRUCTURAL STEEL PLATES & BASE. APPLICATION PER MANUFACTURER SPECIFICATIONS).
- DOOR DESIGNATION  
REFER TO DOOR SCHEDULE
- WINDOW DESIGNATION  
REFER TO WINDOW SCHEDULE
- DROP SOFFITS G.W.B. SOFFIT AT 8'-4" (U.O.N) A.F.F. WITHIN UNITS AND 8'-4" (U.O.N) A.F.F. BREEZEWAY CORRIDOR, METAL FRAME. REFER TO DETAIL 22/A7.03

F.E. PROVIDE FIRE EXT. 2A 40BC TYPE (FIRE EXTINGUISHER TO COMPLY W/F.B.C. CHAPTER 36 F.F.P.C. 7.6.3.1 & N.F.P.A 10) MAXIMUM TRAVEL DISTANCE TO A FIRE EXTINGUISHER - 75 FT FOR ORDINARY HAZARD AREAS. FIRE EXTINGUISHERS SHOULD BE MOUNTED MINIMUM 4 INCHES AND MAXIMUM 5FT FROM FLOOR, IF FIRE EXTINGUISHER IS LESS THAN 40LB IN WEIGHT.

ALL INSULATION MATERIALS TO HAVE A FLAME SPREAD INDEX OF NOT MORE THAN 25 AND A SMOKE-DEVELOPED INDEX OF NOT MORE THAN 450. PER FBC 7th EDITION (2020), SECT 719.2

REVISIONS:	
REV.	REV. ISSUE
1	05/10/2022
2	06/28/2022

2203

GATEWAY LUXURY  
APARTMENTS  
LOCATED AT:  
950 N POWERLINE ROAD,  
POMPANO BEACH FL 33069

BURGOS LANZA & ASSOCIATES  
1249 S ALHAMBRA CIRCLE  
CORAL GABLES, FL 33146  
(766) 554-9035  
AIA 38062598  
WWW.BURGOSLANZA.COM  
PABLO BURGOS ARCHITECT AIA 001681  
CARLOS LANZA ARCHITECT AIA 001681

BURGOS  
LANZA  
ARCHITECTS & PLANNERS  
AIA 28001519

Pablo  
Burgos  
Digitally signed by Pablo Burgos  
DN: cn=Pablo Burgos, o=Burgos  
Lanza & Assoc., ou=AR05925,  
email=pburgos@burgoslanza.co  
m, c=US  
Date: 2022.06.30 06:14:06 -0400'

DATE 11/09/21  
DRAWN CR  
PROJECT No. 2203  
SCALE AS-SHOWN

THIRD FLOOR PLAN  
BUILDING #2  
SCALE: 1/8" = 1' - 0"  
A1123

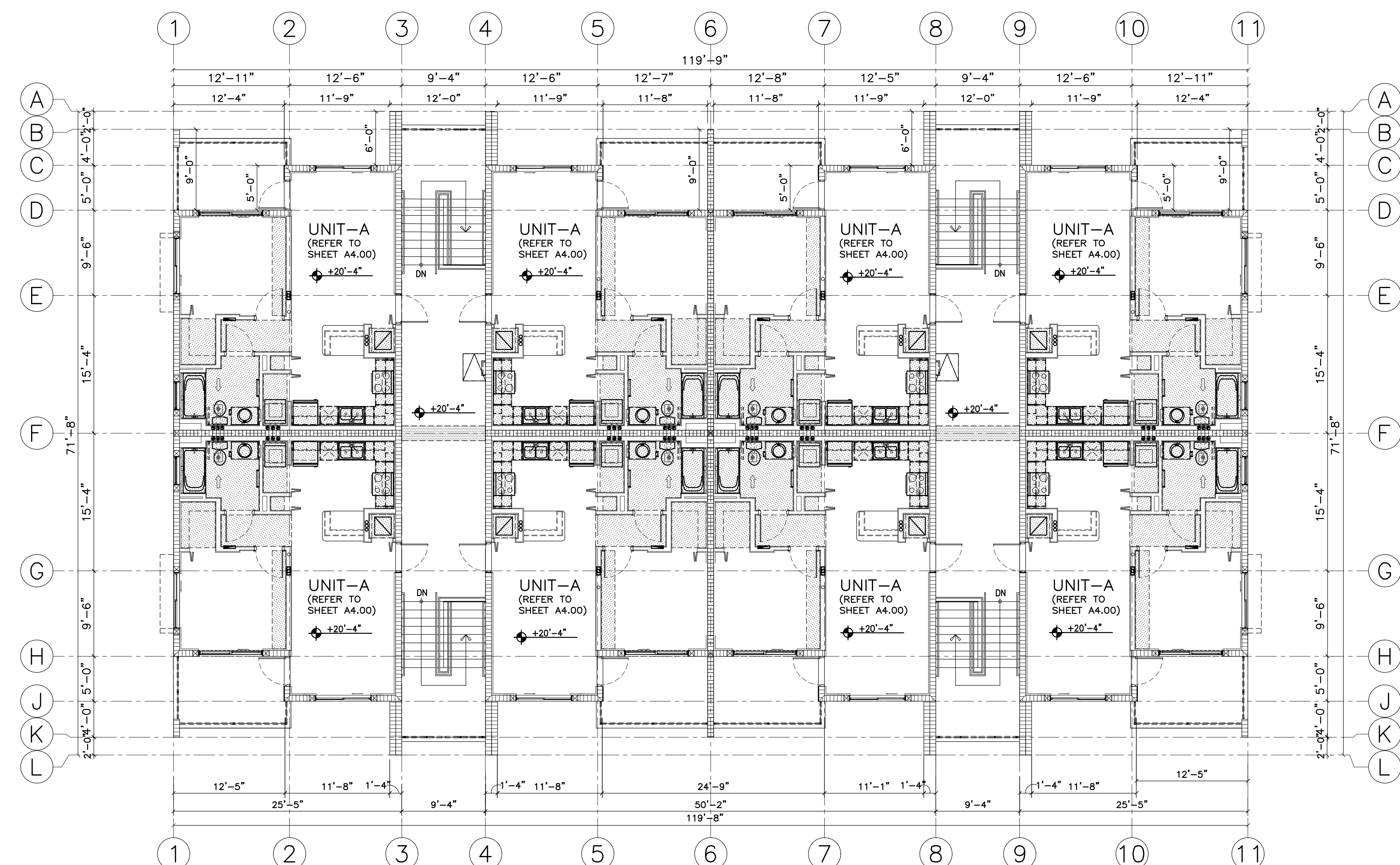

THIRD FLOOR PLAN\_BUILDING #2

SCALE: 1/8" = 1'-0"

DRC  
PZ22-12000008  
8/17/2022